

Basortub

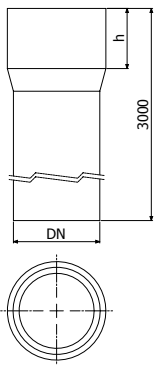

Soluciones en tubo rígido y flexible

TUBO RÍGIDO ABOCARDADO LIBRE DE HALÓGENOS RE1250 RLH



| | DN | h | RLH 7035 | | |
|-----------|----|----|----------|------------|------------|
| | | | REF. | Paquete(m) | Pallet (m) |
| RE1250 16 | 16 | 14 | 206453 | 114 | 3.990 |
| RE1250 20 | 20 | 16 | 206454 | 57 | 2.565 |
| RE1250 25 | 25 | 20 | 206455 | 57 | 1.824 |
| RE1250 32 | 32 | 22 | 206456 | 30 | 1.050 |
| RE1250 40 | 40 | 26 | 206457 | 15 | 720 |
| RE1250 50 | 50 | 31 | 206458 | 15 | 525 |



Tubo rígido según: **UNE-EN 61386-21 Cod.4322**. No propagador de la llama: **V2** según Norma **UL94**
 Libre de halógenos **<0,07% UNE-EN 50642**. Rango de temperatura: **-5°C a +90°C**. Grado de protección **IP:54**;
IK:07. Resistencia al impacto **2J**. Alta resistencia a la compresión: **1250N**.

MANGUITO DE UNIÓN JUR1250



| | DN | L | IP | RLH 7035 | | |
|------------|----|----|----|----------|-------------|------------|
| | | | | REF. | Bolsa (uds) | Caja (uds) |
| JUR1250 16 | 16 | 50 | 40 | 206732 | 40 | 240 |
| JUR1250 20 | 20 | 55 | 40 | 206733 | 20 | 240 |
| JUR1250 25 | 25 | 60 | 40 | 206734 | 20 | 140 |
| JUR1250 32 | 32 | 70 | 40 | 206735 | 10 | 50 |
| JUR1250 40 | 40 | 80 | 40 | 206736 | 8 | 48 |
| JUR1250 50 | 50 | 90 | 40 | 206737 | - | 16 |

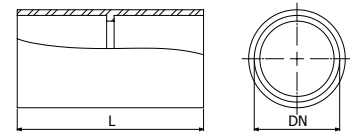

CURVA PLANA 90° CPR



| | DN | R | IP | RLH 7035 | | PVC 7035 | |
|--------|----|-----|----|----------|------------|----------|------------|
| | | | | REF. | Caja (uds) | REF. | Caja (uds) |
| CPR 16 | 16 | 54 | 40 | 206739 | 50 | 218790 | 50 |
| CPR 20 | 20 | 67 | 40 | 206740 | 50 | 218791 | 50 |
| CPR 25 | 25 | 85 | 40 | 206741 | 25 | 218792 | 25 |
| CPR 32 | 32 | 110 | 40 | 206742 | 25 | 218793 | 25 |
| CPR 40 | 40 | 138 | 40 | 206743 | 15 | 218794 | 15 |
| CPR 50 | 50 | 172 | 40 | 206744 | 5 | 218795 | 5 |

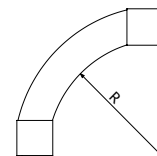

CURVA FLEXIBLE CFR



| | DN | L | IP | RLH 7035 | | |
|--------|----|-----|----|----------|-------------|------------|
| | | | | REF. | Bolsa (uds) | Caja (uds) |
| CFR 16 | 16 | 220 | 65 | 206819 | 10 | 40 |
| CFR 20 | 20 | 230 | 65 | 206820 | 10 | 150 |
| CFR 25 | 25 | 540 | 65 | 206821 | 5 | 85 |
| CFR 32 | 32 | 270 | 65 | 206822 | - | 20 |
| CFR 40 | 40 | 300 | 65 | 206823 | 5 | 35 |
| CFR 50 | 50 | 340 | 65 | 206824 | 10 | 20 |

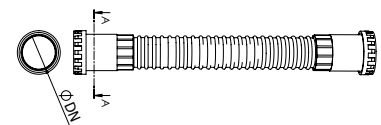

CONECTOR MCR1250



| | DN | L | A | IP | RLH 7035 | | |
|------------|----|----|----|----|----------|-------------|------------|
| | mm | mm | mm | | REF. | Bolsa (uds) | Caja (uds) |
| MCR1250 16 | 16 | 15 | 42 | 67 | 206746 | 25 | 500 |
| MCR1250 20 | 20 | 15 | 44 | 67 | 206747 | 25 | 600 |
| MCR1250 25 | 25 | 15 | 47 | 67 | 206748 | 25 | 400 |
| MCR1250 32 | 32 | 16 | 52 | 67 | 206749 | 15 | 210 |
| MCR1250 40 | 40 | 16 | 64 | 67 | 206750 | 10 | 100 |
| MCR1250 50 | 50 | 18 | 72 | 67 | 206751 | 5 | 70 |

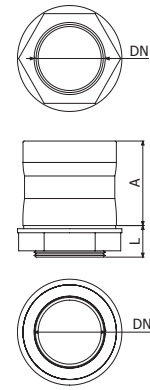

SOPORTE SPR1250



| | DN | A | B | C | RLH 7035 | | |
|------------|----|----|----|----|----------|-------------|------------|
| | mm | mm | mm | mm | REF. | Bolsa (uds) | Caja (uds) |
| SPR1250 16 | 16 | 12 | 25 | 21 | 206753 | 100 | 1.000 |
| SPR1250 20 | 20 | 12 | 28 | 26 | 206754 | 100 | 500 |
| SPR1250 25 | 25 | 12 | 32 | 31 | 206755 | 100 | 2.000 |
| SPR1250 32 | 32 | 12 | 43 | 44 | 206756 | 50 | 300 |
| SPR1250 40 | 40 | 14 | 50 | 52 | 206757 | 50 | 600 |
| SPR1250 50 | 50 | 14 | 56 | 62 | 206758 | 25 | 500 |

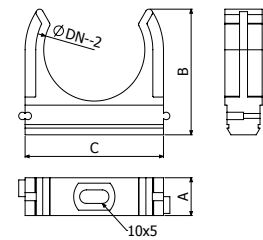

ABRAZADERA ABR 1250



| | DN | F | RLH 7035 | | |
|---------------|-------|----|----------|-------------|------------|
| | mm | kg | REF. | Bolsa (uds) | Caja (uds) |
| ABR1250 16-32 | 16/32 | 15 | 206760 | 50 | 2.000 |
| ABR1250 20-63 | 20/63 | 15 | 206761 | 100 | 1.000 |

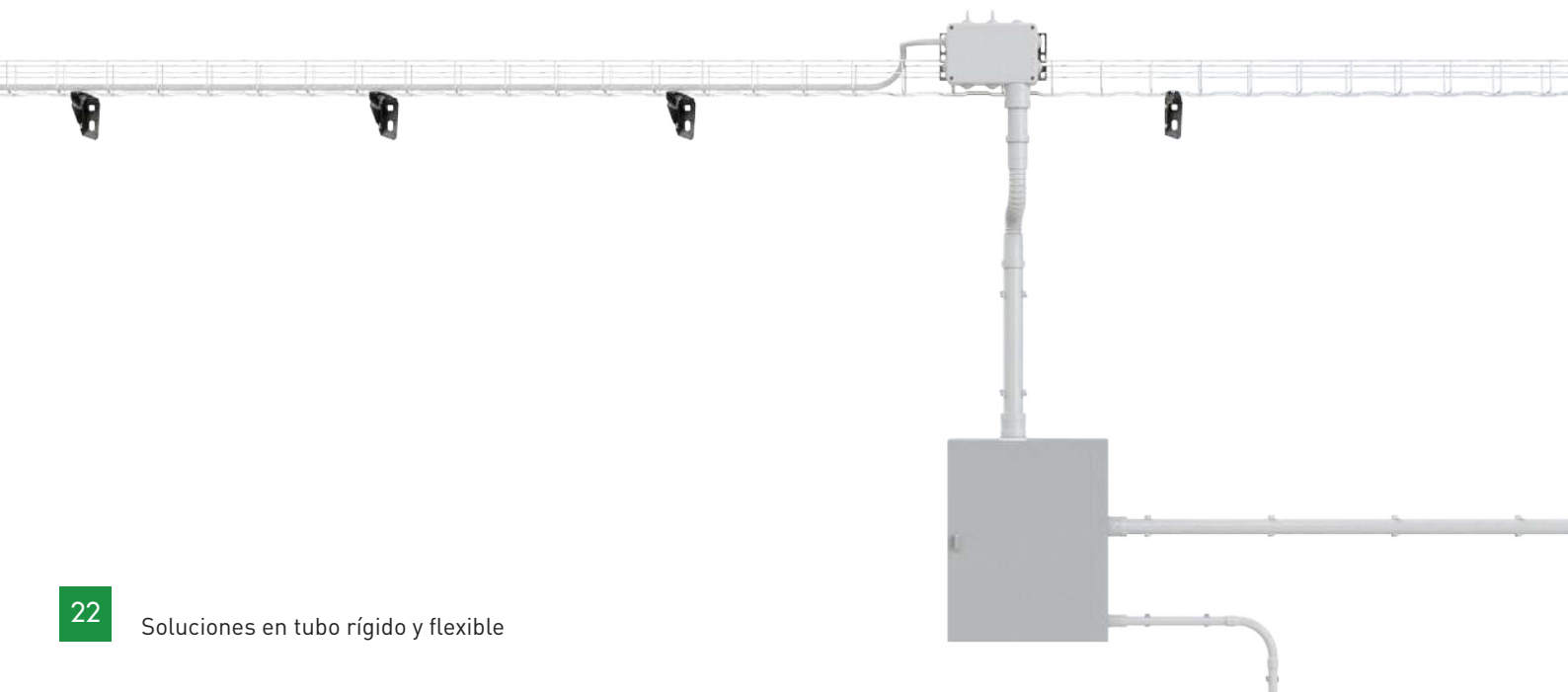
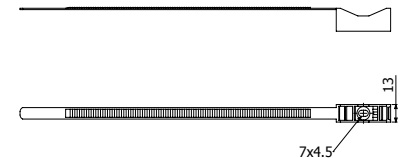

COFLEX



| | Dext | Dint | L | RLH 7035 | | |
|-----------|------|------|-----|----------|-----------|------------|
| | mm | mm | | REF. | Rollo (m) | Pallet (m) |
| COFLEX 16 | 16 | 11 | 100 | 206995 | 100 | 7.000 |
| COFLEX 20 | 20 | 15 | 100 | 206996 | 100 | 4.800 |
| COFLEX 25 | 25 | 20 | 75 | 206997 | 75 | 3.300 |
| COFLEX 32 | 32 | 27 | 50 | 206998 | 50 | 2.200 |
| COFLEX 40 | 40 | 34 | 25 | 206999 | 25 | 1.200 |
| COFLEX 50 | 50 | 44 | 25 | 207000 | 25 | 800 |

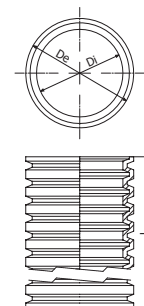

Tubo corrugado curvable según: **UNE-EN 61386-23 Cod.2322**. No propagador de la llama. Libre de halógenos según: **<0,4% UNE-EN 50642**. Rango de temperatura: **-5°C a +90°C**. Resistencia al impacto **2J**. Resistencia a la compresión: **390N**.

CONECTOR MCR1250



| | DN | L | A | IP | RLH 7035 | | |
|------------|----|----|----|----|----------|-------------|------------|
| | mm | mm | mm | | REF. | Bolsa (uds) | Caja (uds) |
| MCR1250 16 | 16 | 15 | 42 | 67 | 206746 | 25 | 500 |
| MCR1250 20 | 20 | 15 | 44 | 67 | 206747 | 25 | 600 |
| MCR1250 25 | 25 | 15 | 47 | 67 | 206748 | 25 | 400 |
| MCR1250 32 | 32 | 16 | 52 | 67 | 206749 | 15 | 210 |
| MCR1250 40 | 40 | 16 | 64 | 67 | 206750 | 10 | 100 |
| MCR1250 50 | 50 | 18 | 72 | 67 | 206751 | 5 | 70 |

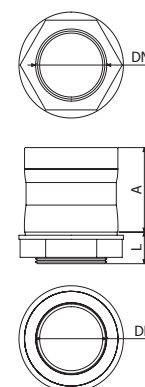

SOPORTE SPR1250



| | DN | A | B | C | RLH 7035 | | |
|------------|----|----|----|----|----------|-------------|------------|
| | mm | mm | mm | mm | REF. | Bolsa (uds) | Caja (uds) |
| SPR1250 16 | 16 | 12 | 25 | 21 | 206753 | 100 | 1.000 |
| SPR1250 20 | 20 | 12 | 28 | 26 | 206754 | 100 | 500 |
| SPR1250 25 | 25 | 12 | 32 | 31 | 206755 | 100 | 2.000 |
| SPR1250 32 | 32 | 12 | 43 | 44 | 206756 | 50 | 300 |
| SPR1250 40 | 40 | 14 | 50 | 52 | 206757 | 50 | 600 |
| SPR1250 50 | 50 | 14 | 56 | 62 | 206758 | 25 | 500 |

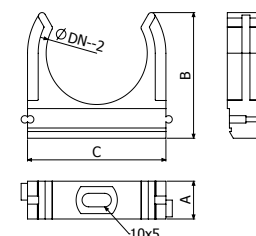

ABRAZADERA ABR1250



| | DN | F | RLH 7035 | | |
|---------------|-------|----|----------|-------------|------------|
| | mm | kg | REF. | Bolsa (uds) | Caja (uds) |
| ABR1250 16-32 | 16/32 | 15 | 206760 | 50 | 2.000 |
| ABR1250 20-63 | 20/63 | 15 | 206761 | 100 | 1.000 |

